

LEGEND

- HEAVY DUTY ASPHALT PAVEMENT (08 C900)
- CONCRETE SIDEWALK (06 C900)
- CONCRETE PAVEMENT (07 C900)
- MANHOLE
- CATCH BASIN
- FLARED END SECTION (03 C901)
- RIP-RAP

GENERAL NOTES

1. THE BASE SURVEY WAS PREPARED BY GRAEF IN 2025. ALL UNDERGROUND UTILITIES AND STRUCTURES HAVE BEEN SHOWN TO A REASONABLE DEGREE OF ACCURACY AND IT SHALL BE THE CONTRACTOR'S RESPONSIBILITY TO VERIFY THEIR EXACT LOCATION AND TO AVOID DAMAGE THERETO.
2. REFER TO SHEET C100 FOR BENCHMARKS, DATUM, AND TOPOGRAPHIC ELEMENTS. THE ACCURACY OF THE BENCHMARKS SHOWN ON THIS PLAN SHALL BE VERIFIED BEFORE BEING UTILIZED. GRAEF DOES NOT WARRANT THE ACCURACY OF THESE BENCHMARKS.
3. BEFORE EXCAVATION, THE APPROPRIATE UTILITY COMPANIES SHOULD BE CONTACTED. FOR EXACT LOCATION OF UNDERGROUND UTILITIES, CONTACT DIGGERS HOTLINE.
4. CONTRACTOR SHALL VERIFY LOCATION OF WORK AND REPORT ANY DISCREPANCIES TO THE ENGINEER PRIOR TO COMMENCING WORK.
5. THE CITY OF WAUKESHA AND GRAEF SHALL BE NOTIFIED 48 HOURS IN ADVANCE OF PERFORMING ANY CONSTRUCTION.
6. GRAEF SHALL BE HELD HARMLESS AND DOES NOT WARRANT ANY DEVIATIONS BY THE OWNER/CONTRACTOR FROM THE APPROVED CONSTRUCTION PLANS THAT MAY RESULT IN DISCIPLINARY ACTION BY ANY OR ALL REGULATORY AGENCIES.
7. ALL WORK WITHIN THE CITY RIGHT OF WAY AND CITY EASEMENTS SHALL BE IN ACCORDANCE WITH CURRENT CITY STANDARD SPECIFICATIONS AND DETAILS.
8. CONTRACTOR SHALL NOTIFY CITY ENGINEERING DEPARTMENT 5 DAYS PRIOR TO WORK IN CITY RIGHT OF WAY.

LAYOUT NOTES

1. THE BUILDING OUTLINES SHOWN ARE FOR REFERENCE PURPOSES ONLY AND SHALL NOT BE USED FOR STAKING PURPOSES. THE CONTRACTOR SHALL COORDINATE WITH THE ARCHITECT AND STRUCTURAL ENGINEER ON THE STAKING OF THE BUILDING.
2. SITE LIGHTS ARE SHOWN FOR REFERENCE PURPOSES ONLY AND THE CONTRACTOR SHALL REFER TO THE ELECTRICAL PLANS FOR DETAIL DESIGN INFORMATION. CONTRACTOR SHALL COORDINATE WITH THE ELECTRICAL ENGINEER ON STAKING OF THE SITE LIGHTS.
3. ALL DIMENSIONS SHOWN ARE TO THE EDGE OF PAVEMENT OR FACE OF CURB WHERE CONCRETE CURB IS SHOWN.
4. STANDARD CURB RADIUS IS 3' UNLESS INDICATED OTHERWISE.
5. ALL PAVEMENT STRIPING SHALL BE YELLOW IN COLOR.
6. REFER TO LANDSCAPING PLANS FOR SITE RESTORATION INFORMATION AND DETAILS.
7. ACCESSIBLE PARKING STALLS SHALL BE FURNISHED WITH A CONCRETE WHEEL STOP WHEN ADJACENT TO FLUSH CONCRETE CURB AND GUTTER.
8. CONTRACTOR SHALL SUBMIT A CONCRETE JOINTING PLAN TO THE ENGINEER FOR REVIEW AND APPROVAL PRIOR TO COMMENCING CONSTRUCTION. JOINTING PLAN SHALL INDICATE: POUR SEQUENCE, LOCATION OF CONSTRUCTION, ISOLATION, CONTRACTION JOINTS, AND TYPE OF REINFORCEMENT.
9. SOME FIELD ADJUSTMENTS MAY BE NECESSARY AT POINTS WHERE PROPOSED PAVEMENT, CURB, AND SIDEWALKS MEET EXISTING PAVEMENT, CURB, AND SIDEWALKS. REVIEW ANY REQUIRED CHANGES WITH THE ENGINEER PRIOR TO CONSTRUCTION OF WORK.
10. LIMITS OF FINAL CITY STREET PAVEMENT AND CURB AND GUTTER REMOVAL AND REPLACEMENTS TO BE MARKED BY CITY ENGINEERING STAFF IN FIELD.

PROJECT TITLE:

WELDALL MFG EXPANSION

2001 S. PRAIRIE AVE.
WAUKESHA, WI 53189

NO. DATE		REVISIONS	ISSUE BY
A	5/23/25	PRELIMINARY DEVELOPMENT REVIEW	
B	6/23/25	FINAL SPAR SUBMITTAL	

PROJECT INFORMATION:

PROJECT NUMBER: 2025-0121.00
DATE: 5/23/2025
DRAWN BY: SRK
CHECKED BY: PMC
APPROVED BY: JPH
SCALE: AS SHOWN

SHEET TITLE:

SITE LAYOUT PLAN

SHEET NUMBER:

C-300

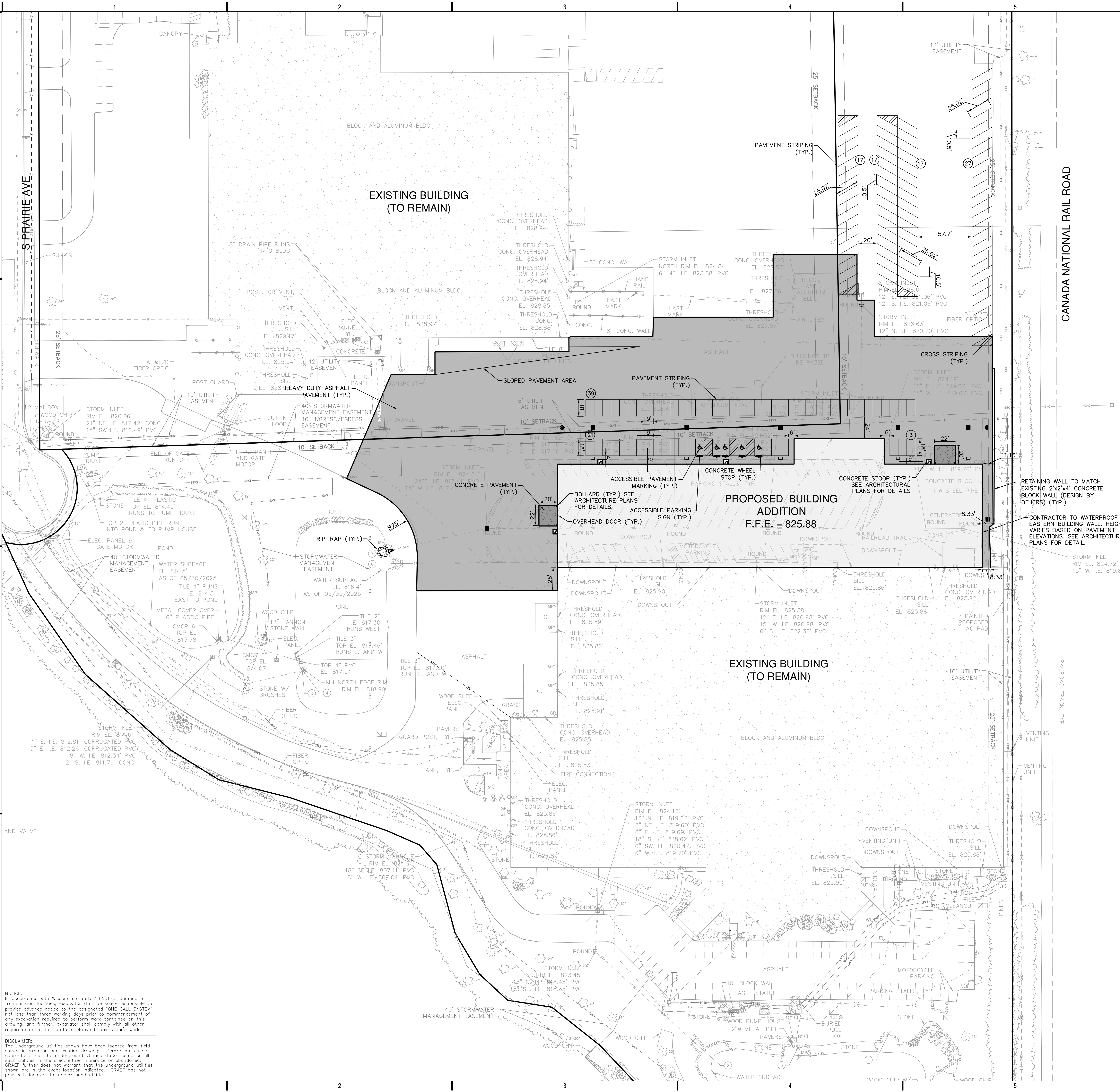

NOTICE:
In accordance with Wisconsin statute 182.0175, damage to transmission facilities, excavator shall be solely responsible to provide advance notice to the designated "ONE CALL SYSTEM" not less than three working days prior to commencement of any excavation required to perform work contained on this drawing, and further, excavator shall comply with all other requirements of this statute relative to excavator's work.

DISCLAIMER:
The underground utilities shown have been located from field survey information and existing drawings. GRAEF makes no guarantee that the underground utilities shown comprise all such utilities in the area, either in service or abandoned. GRAEF further does not warrant that the underground utilities shown are in the exact location indicated. GRAEF has not physically located the underground utilities.